

# ALPINIA

## Washbasin tap



Product code: BGA\_N20M

EAN: 5907650815365

Color: nero

Warranty [years]: 7

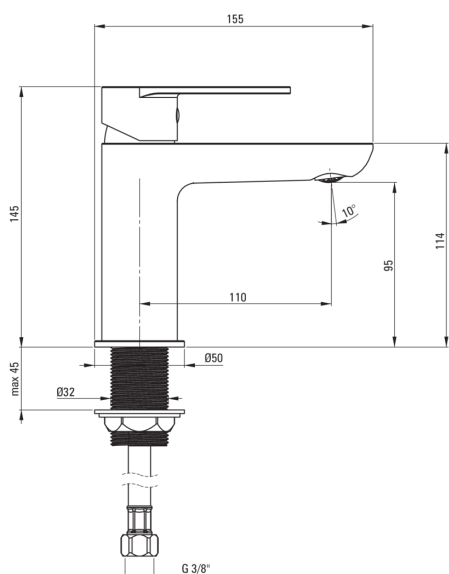

### Mixer

Finish	nero
Mixer type	single-handle, mixer
Installation method	standing
Flow class [l/min]	Z - 4-9 l/min
Acoustic group [db]	I ( $x \leq 20$ )

### Mixer cartridge

Ceramic cartridge size	35 mm
------------------------	-------

### Spout

Spout type	still
Mixer spout range [mm]	110
Material	brass

### Aerator

Aerator type	coin-slot
Aerator size	M24

### Connecting hose

Length [mm]	450
Installation thread	3/8"
Connection thread	M10

### Features:

- Light and subtle design
- Coin-slot aerator
- Z flow class (4-9 l/min) allowing for water consumption reduction
- The mounting sleeve facilitates the installation of the mixer
- 45 cm connection hoses included
- Innovative, durable and easy to clean Nero coating
- Only the best materials, the quality of which has been confirmed by laboratory tests
- The mixer body is made of the highest quality brass
- The mixer is equipped with a stream aerator
- The offer includes a cleaning agent for fixtures in all colors